

A

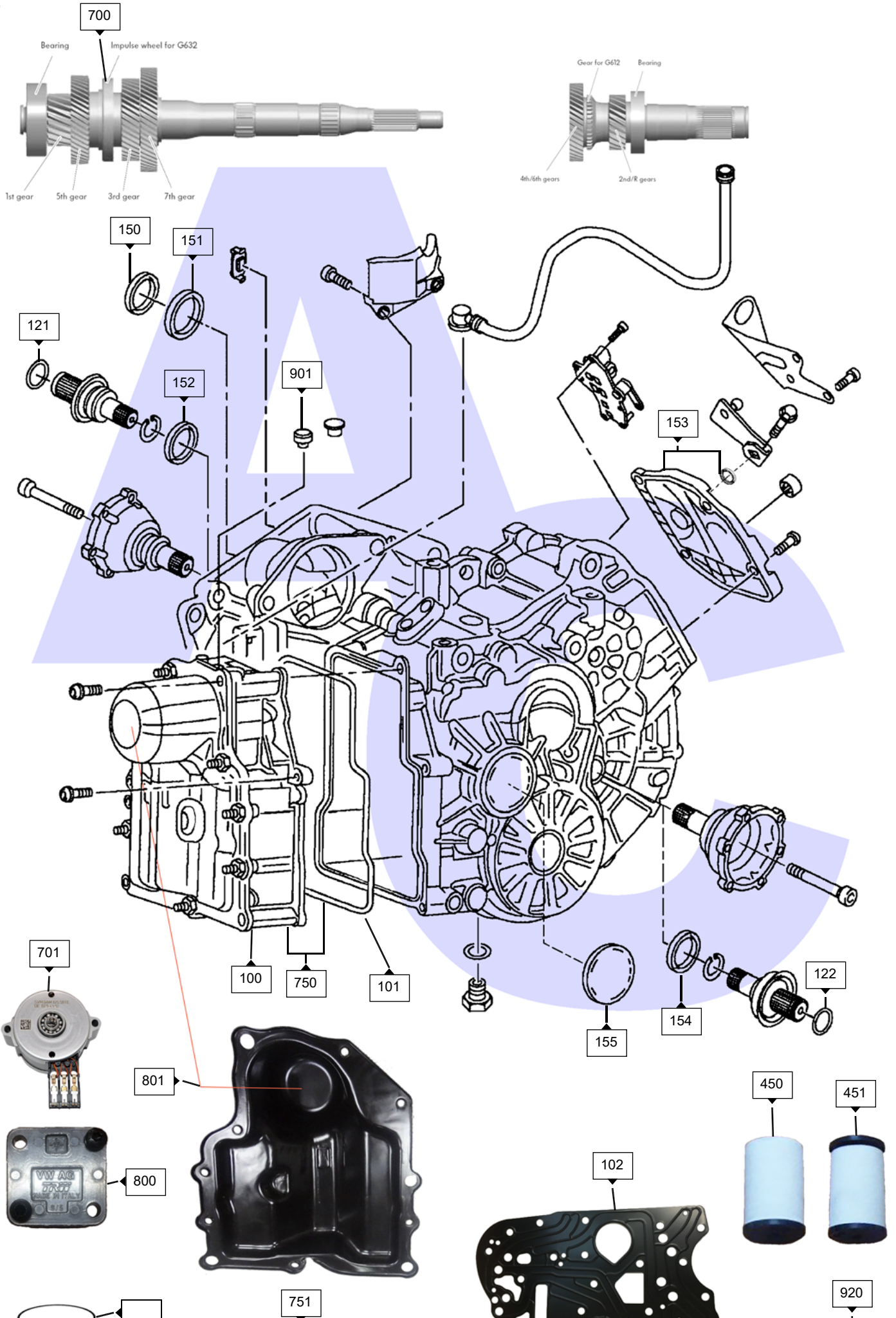

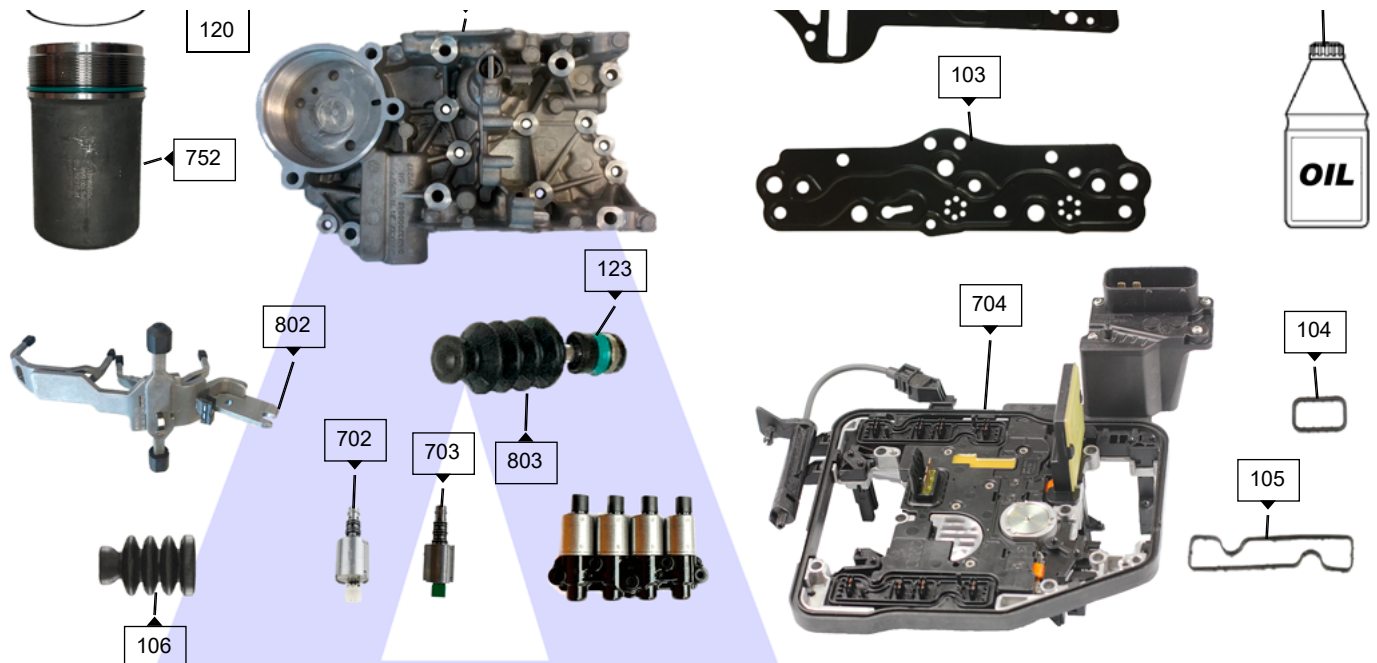

	0AM/DQ200 O-RING AND SEAL KIT	1	0AM.ORK01
	0AM/DQ200 O-RING AND SEAL KIT	1	0AM.ORK11
	M 0AM/DQ200 OIL CHANGE KIT	1	0AM.SERKIT01
	M 0AM/DQ200 OIL CHANGE KIT	1	0AM.SERKIT02
	0AM/DQ200 SOLENOID BLOCK	1	0AM.SOL01
450	0AM/DQ200 MECHATRONIC FILTER	1	0AM.FIL11
451	0AM/DQ200 MECHATRONIC FILTER	1	0AM.FIL02
451	0AM/DQ200 MECHATRONIC FILTER	1	0AM.FIL12
750	0AM/DQ200 MECHATRONIC 0AM 325 025 M Z0X NEW CODED	1	0AM.VB03
750	0AM/DQ200 MECHATRONIC 0AM 325 025 D/H WITH TCM 0AM 927 769 D	1	0AM.VB12
750	0AM/DQ200 VALVE BODY - REMAN (DOES NOT INCLUDE TCM)	1	0AM.VB13
750	0AM/DQ200 MECHATRONIC REMAN - 0AM 325 025 L WITH TCM 0AM 927 769 G	1	0AM.VB14
750	0AM/DQ200 MECHATRONIC REMAN (2013-) - 0AM 325 025 M WITH TCM 0AM 927 769 K	1	0AM.VB15
750	0AM/DQ200 MECHATRONIC 0AM 325 026 E	1	0AM.VB18
750	0AM/DQ200 MECHATRONIC REPAIR	1	0AM.VB31
750	0CW/DQ200 MECHATRONIC	1	0CW.VB01
751	0AM/DQ200 MECHATRONIC REPAIR KIT	1	0AM.REP01
920	0AMDQ200 TRANSMISSION OIL	AR	0AM.OIL01
920	0AMDQ200 MECHATRONIC OIL	1	0AM.OIL02

	0AM/DQ200 ROLLER BEARING	1	0AM.BE09
	0AM/DQ200 ROLLER BEARING	1	0AM.BE10
	0AM/DQ200 BALL BEARING	1	0AM.BE11
	0AM/DQ200 BALL BEARING	1	0AM.BE12
	0AM/DQ200 TAPERED ROLLER BEARING	1	0AM.BE13
	M 0AM/DQ200 BEARING & SEAL KIT	1	0AM.BSK01
	0AM/DQ200 BEARING & SEAL KIT	1	0AM.BSK11
	0AM/DQ200 CLUTCH ADJUSTING WASHER	AR	0AM.SHIM01
	0AM/DQ200 CLUTCH ADJUSTING WASHER	AR	0AM.SHIM02
	0AM/DQ200 CLUTCH ADJUSTING WASHER	AR	0AM.SHIM03
	0AM/DQ200 CLUTCH ADJUSTING WASHER	AR	0AM.SHIM04
	0AM/DQ200 CLUTCH ADJUSTING WASHER	AR	0AM.SHIM05
	0AM/DQ200 CLUTCH ADJUSTING WASHER	AR	0AM.SHIM06
	0AM/DQ200 CLUTCH ADJUSTING WASHER	AR	0AM.SHIM07
	0AM/DQ200 CLUTCH ADJUSTING WASHER	AR	0AM.SHIM08
	0AM/DQ200 CLUTCH ADJUSTING WASHER	AR	0AM.SHIM09
	0AM/DQ200 CLUTCH ADJUSTING WASHER	AR	0AM.SHIM10
	0AM/DQ200 CLUTCH ADJUSTING WASHER	AR	0AM.SHIM11
	0AM/DQ200 LARGE CLUTCH ADJUSTING WASHER	AR	0AM.SHIM12
	0AM/DQ200 LARGE CLUTCH ADJUSTING WASHER	AR	0AM.SHIM13
	0AM/DQ200 LARGE CLUTCH ADJUSTING WASHER	AR	0AM.SHIM14
	0AM/DQ200 LARGE CLUTCH ADJUSTING WASHER	AR	0AM.SHIM15
	0AM/DQ200 LARGE CLUTCH ADJUSTING WASHER	AR	0AM.SHIM16
	0AM/DQ200 LARGE CLUTCH ADJUSTING WASHER	AR	0AM.SHIM17
	0AM/DQ200 LARGE CLUTCH ADJUSTING WASHER	AR	0AM.SHIM18
	0AM/DQ200 LARGE CLUTCH ADJUSTING WASHER	AR	0AM.SHIM19
	0AM/DQ200 LARGE CLUTCH ADJUSTING WASHER	AR	0AM.SHIM20
	0AM/DQ200 LARGE CLUTCH ADJUSTING WASHER	AR	0AM.SHIM21
	0AM/DQ200 LARGE CLUTCH ADJUSTING WASHER	AR	0AM.SHIM22
	0AM/DQ200 SHIMKIT	1	0AM.SHIMKIT01
	0AM/DQ200 SHIMKIT	1	0AM.SHIMKIT02
	0AM/DQ200 SLEEVE	1	0AM.SL01
	0AM/DQ200 SELECTIVE SHIM	AR	0AM.THW01

Bolts, Nuts & Mounting Parts

REF	DESCRIPTION	QUANTITY	PART NO
	0AM/DQ200 SLEEVE	1	0AM.SL01
901	AG4 CASE BREATHER CAP (DIFF SIDE)	1	AG4.BRE01

Clutches, Flywheels & Parts

REF	DESCRIPTION	QUANTITY	PART NO
	0AM/DQ200 CLUTCH KIT	1	0AM.CK01
	0AM/DQ200 CLUTCH KIT	1	0AM.CK02
	0AM/DQ200 CLUTCH KIT	1	0AM.CK03
	0AM/DQ200 CLUTCH KIT	1	0AM.CK04
	0AM/DQ200 CLUTCH KIT	1	0AM.CK06
	0AM/DQ200 CLUTCH KIT	1	0AM.CK21
	0AM/DQ200 CLUTCH KIT	1	0AM.CK22
	0AM/DQ200 CLUTCH KIT	1	0AM.CK23
	0AM/DQ200 CLUTCH KIT	1	0AM.CK24
	0AM/DQ200 CLUTCH KIT	1	0AM.CK25
	0AM/DQ200 DUAL MASS FLYWHEEL	1	0AM.FLY01

	0AM/DQ200 DUAL MASS FLYWHEEL	1	0AM.FLY02
	0AM/DQ200 DUAL MASS FLYWHEEL	1	0AM.FLY03
	0AM/DQ200 DUAL MASS FLYWHEEL	1	0AM.FLY04
	0AM/DQ200 DUAL MASS FLYWHEEL	1	0AM.FLY06
	0AM/DQ200 DUAL MASS FLYWHEEL	1	0AM.FLY08
	0AM/DQ200 DUAL MASS FLYWHEEL	1	0AM.FLY09
	0AM/DQ200 DUAL MASS FLYWHEEL	1	0AM.FLY11
	0AM/DQ200 DUAL MASS FLYWHEEL VAG	1	0AM.FLY12
	0AM/DQ200 CLUTCH ADJUSTING WASHER	AR	0AM.SHIM01
	0AM/DQ200 CLUTCH ADJUSTING WASHER	AR	0AM.SHIM02
	0AM/DQ200 CLUTCH ADJUSTING WASHER	AR	0AM.SHIM03
	0AM/DQ200 CLUTCH ADJUSTING WASHER	AR	0AM.SHIM04
	0AM/DQ200 CLUTCH ADJUSTING WASHER	AR	0AM.SHIM05
	0AM/DQ200 CLUTCH ADJUSTING WASHER	AR	0AM.SHIM06
	0AM/DQ200 CLUTCH ADJUSTING WASHER	AR	0AM.SHIM07
	0AM/DQ200 CLUTCH ADJUSTING WASHER	AR	0AM.SHIM08
	0AM/DQ200 CLUTCH ADJUSTING WASHER	AR	0AM.SHIM09
	0AM/DQ200 CLUTCH ADJUSTING WASHER	AR	0AM.SHIM10
	0AM/DQ200 CLUTCH ADJUSTING WASHER	AR	0AM.SHIM11
	0AM/DQ200 LARGE CLUTCH ADJUSTING WASHER	AR	0AM.SHIM12
	0AM/DQ200 LARGE CLUTCH ADJUSTING WASHER	AR	0AM.SHIM13
	0AM/DQ200 LARGE CLUTCH ADJUSTING WASHER	AR	0AM.SHIM14
	0AM/DQ200 LARGE CLUTCH ADJUSTING WASHER	AR	0AM.SHIM15
	0AM/DQ200 LARGE CLUTCH ADJUSTING WASHER	AR	0AM.SHIM16
	0AM/DQ200 LARGE CLUTCH ADJUSTING WASHER	AR	0AM.SHIM17
	0AM/DQ200 LARGE CLUTCH ADJUSTING WASHER	AR	0AM.SHIM18
	0AM/DQ200 LARGE CLUTCH ADJUSTING WASHER	AR	0AM.SHIM19
	0AM/DQ200 LARGE CLUTCH ADJUSTING WASHER	AR	0AM.SHIM20
	0AM/DQ200 LARGE CLUTCH ADJUSTING WASHER	AR	0AM.SHIM21
	0AM/DQ200 LARGE CLUTCH ADJUSTING WASHER	AR	0AM.SHIM22
	0AM/DQ200 SHIMKIT	1	0AM.SHIMKIT01
	0AM/DQ200 SHIMKIT	1	0AM.SHIMKIT02
	0CW/DQ200 DUAL MASS FLYWHEEL	1	DSG.FLY22
803	0AM/DQ200 CLUTCH RELEASE ROD	2	0AM.ROD01
803	0AM/DQ200 CLUTCH RELEASE ROD	1	0AM.ROD02

Dipsticks, Oil & Related Parts

REF	DESCRIPTION	QUANTITY	PART NO
	M 0AM/DQ200 OIL CHANGE KIT	1	0AM.SERKIT01
	M 0AM/DQ200 OIL CHANGE KIT	1	0AM.SERKIT02
920	0AMDQ200 TRANSMISSION OIL	AR	0AM.OIL01
920	0AMDQ200 MECHATRONIC OIL	1	0AM.OIL02

Electrical Parts

REF	DESCRIPTION	QUANTITY	PART NO
	0AM/DQ200 TCM REPAIR	1	0AM.ELE42
	0AM/DQ200 SOLENOID BLOCK	1	0AM.SOL01
	M 0AM/DQ200 SOLENOID SET	1	0AM.SOL20
700	0AM/DQ200 SENSOR WHEEL	1	0AM.ELE11
701	0AM/DQ200 HYDRAULIC PUMP MOTOR	1	0AM.PUM01
702	0AM/DQ200 PRESSURE SOLENOID	1	0AM.SOL02
703	0AM/DQ200 SHIFT SOLENOID	6	0AM.SOL03
704	0AM/DQ200 BLANK TCM - 0AM 927 769 F - SEE DETAIL PAGE FOR IMPORTANT NOTE ABOUT TCM	1	0AM.ELE02
704	0AM/DQ200 BLANK TCM - 0AM 927 769 K - SEE DETAIL PAGE FOR IMPORTANT NOTE ABOUT TCM	1	0AM.ELE03
704	0AM/DQ200 BLANK TCM - 0AM 927 769 E - SEE DETAIL PAGE FOR IMPORTANT NOTE ABOUT TCM	1	0AM.ELE04

Filters & Screens

REF	DESCRIPTION	QUANTITY	PART NO
	M 0AM/DQ200 OIL CHANGE KIT	1	0AM.SERKIT01
	M 0AM/DQ200 OIL CHANGE KIT	1	0AM.SERKIT02
450	0AM/DQ200 MECHATRONIC FILTER	1	0AM.FIL11
451	0AM/DQ200 MECHATRONIC FILTER	1	0AM.FIL02
451	0AM/DQ200 MECHATRONIC FILTER	1	0AM.FIL12
751	0AM/DQ200 MECHATRONIC REPAIR KIT	1	0AM.REP01

Gaskets, Seals & Closing Parts

REF	DESCRIPTION	QUANTITY	PART NO
	0AM/DQ200 VALVE BODY GASKET KIT	1	0AM.GK01
	0AM/DQ200 HYDRAULIC PUMP GASKET KIT	1	0AM.GK02
	0AM/DQ200 MECHATRONIC GASKET KIT	1	0AM.GK03
	M 0AM/DQ200 VALVE BODY GASKET KIT	1	0AM.GK11
	0AM/DQ200 GASKET & SEAL KIT	1	0AM.GSK01
	M 0AM/DQ200 GASKET & SEAL KIT	1	0AM.GSK11
	0AM/DQ200 O-RING AND SEAL KIT	1	0AM.ORK01
	0AM/DQ200 O-RING AND SEAL KIT	1	0AM.ORK11
	M 0AM/DQ200 OIL CHANGE KIT	1	0AM.SERKIT02
	0AM/DQ200 MECHATRONIC CLUTCH ACTUATOR SUBKIT	1	0AM.SUBKIT02
100	0AM/DQ200 MECHATRONIC COVER GASKET	1	0AM.GAS01
100	0AM/DQ200 MECHATRONIC COVER GASKET	1	0AM.GAS11
100	0AM/DQ200 MECHATRONIC COVER GASKET	1	0AM.GAS51
100	0AM/DQ200 MECHATRONIC ECU COVER SEAL	1	0AM.GAS55
101	0AM/DQ200 MECHATRONIC TO CASE GASKET	1	0AM.GAS02
101	0AM/DQ200 MECHATRONIC TO CASE GASKET	1	0AM.GAS12
101	0AM/DQ200 MECHATRONIC TO CASE GASKET	1	0AM.GAS52
102	0AM/DQ200 VALVE BODY GASKET	1	0AM.GAS03
102	0AM/DQ200 VALVE BODY GASKET	1	0AM.GAS13
103	0AM/DQ200 VALVE BODY SOLENOID HOUSING GASKET	2	0AM.GAS04
103	0AM/DQ200 VALVE BODY SOLENOID HOUSING GASKET	1	0AM.GAS14
104	0AM/DQ200 MECHATRONIC ELECTRIC MOTOR CONNECTOR SEAL	1	0AM.GAS05
105	0AM/DQ200 SOLENOID CONNECTOR GASKET	1	0AM.GAS06
106	0AM/DQ200 PISTON ROD BELLOWS	2	0AM.GAS07
155	0AM/DQ200 COVER CASE SHAFT	1	0AM.COV01

Housings, Cases & Parts

REF	DESCRIPTION	QUANTITY	PART NO
	M 0AM/DQ200 OIL CHANGE KIT	1	0AM.SERKIT01
	M 0AM/DQ200 OIL CHANGE KIT	1	0AM.SERKIT02
153	0AM/DQ200 SELECTOR SHAFT OIL SEAL & COVER PLATE	1	0AM.MCS05
801	0AM/DQ200 VALVEBODY SIDE COVER - AM	1	0AM.PAN01
801	0AM/DQ200 VALVEBODY SIDE COVER - OE	1	0AM.PAN11
901	AG4 CASE BREATHER CAP (DIFF SIDE)	1	AG4.BRE01

Manuals, Tools & Consumables

REF	DESCRIPTION	QUANTITY	PART NO
	08D 6 SPD MANUAL SUPPORT BRIDGE	1	08D.TOOL01
	0AM/DQ200 MECHATRONIC ASSEMBLY LEVER TOOL	1	0AM.TOOL02
	0AM/DQ200 SETTING TOOL DUAL CLUTCH RELEASE BEARING K1&K2	1	0AM.TOOL03
	0AM/DQ200 CLUTCH/FLYWHEEL MOUNTING TOOL SET	1	0AM.TOOL04
	0AM/DQ200 CLUTCH/FLYWHEEL MOUNTING SUPPLEMENTARY TOOL SET	1	0AM.TOOL05
	0AM/DQ200 TOOLKIT	1	0AM.TOOL06
	0AM/DQ200 SUPPLEMENTARY TOOLKIT	1	0AM.TOOL07
	0AM/DQ200 SETTING TOOL DUAL CLUTCH RELEASE BEARING K1&K2	1	0AM.TOOL08
	0AM/DQ200 INPUT SEAL EXTRACTOR TOOL	1	0AM.TOOL09
	0AM/DQ200 INPUT SEAL INSTALLER TOOL	1	0AM.TOOL10
	0AM/DQ200 MECHATRONIC GUIDE BOLT/PIN	1	0AM.TOOL11
	0AM/DQ200 CLUTCH INSTALL/PRESSING TOOL	1	0AM.TOOL12

155	0AM/DQ200 COVER CASE SHAFT	1	0AM.COV11
751	0AM/DQ200 MECHATRONIC REPAIR KIT	1	0AM.REP01

	0AM/DQ200 DUAL CLUTCH REMOVAL TOOL	1	0AM.TOOL13
	0AM/DQ200 SELECTOR LEVER SETTING	1	0AM.TOOL14
	0AM/0CWDQ200 DUAL CLUTCH REMOVAL AND INSTALL TOOL	1	0AM.TOOL15
	0AM/DQ200 CLUTCH/FLYWHEEL MOUNTING BASIC TOOL SET	1	TOOL.225

Metal Clad Seals & Seal Rings

REF	DESCRIPTION	QUANTITY	PART NO
	0AM/DQ200 GASKET & SEAL KIT	1	0AM.GSK01
	M 0AM/DQ200 GASKET & SEAL KIT	1	0AM.GSK11
	0AM/DQ200 MECHATRONIC TO PRESSURE SENSOR O-RING	1	0AM.OR03
	0AM/DQ200 OIL PUMP O-RING	1	0AM.OR04
	0AM/DQ200 O-RING AND SEAL KIT	1	0AM.ORK01
	0AM/DQ200 SOLENOID O-RING KIT	1	0AM.ORK02
	0AM/DQ200 O-RING AND SEAL KIT	1	0AM.ORK11
	0AM/DQ200 MECHATRONIC CLUTCH ACTUATOR SUBKIT	1	0AM.SUBKIT02
	0AM/DQ200 MECHATRONIC GEAR SELECTORS SUBKIT	1	0AM.SUBKIT03
120	4HP18/5HP18/5HP19 F CL MOD O RING ALSO 0AM ACC ORING	1	5HP18.OR01
121	0AM/DQ200 DRIVESHAFT SPLINE O-RING	2	0AM.OR02
123	0AM/DQ200 CLUTCH RELEASE ROD SEAL	1	0AM.LIP01
150	0AM/DQ200 INPUT SHAFT INNER METAL CLAD SEAL	1	0AM.MCS02
150	0AM/DQ200 INPUT SHAFT INNER METAL CLAD SEAL	1	0AM.MCS12
151	0AM/DQ200 INPUT SHAFT OUTER METAL CLAD SEAL	1	0AM.MCS01
151	0AM/DQ200 INPUT SHAFT OUTER METAL CLAD SEAL	1	0AM.MCS11
151	0AM/DQ200 INPUT SHAFT OUTER METAL CLAD SEAL	1	0AM.MCS51
152	0AM/DQ200 RH DRIVESHAFT METAL CLAD SEAL	1	0AM.MCS03
153	0AM/DQ200 SELECTOR SHAFT OIL SEAL & COVER PLATE	1	0AM.MCS05
154	0AM/DQ200 LH DRIVESHAFT METAL CLAD SEAL	1	0AM.MCS04
751	0AM/DQ200 MECHATRONIC REPAIR KIT	1	0AM.REP01

Overhaul, Repair & Gasket Kits

REF	DESCRIPTION	QUANTITY	PART NO
	M 0AM/DQ200 BEARING & SEAL KIT	1	0AM.BSK01
	0AM/DQ200 BEARING & SEAL KIT	1	0AM.BSK11
	0AM/DQ200 VALVE BODY GASKET KIT	1	0AM.GK01
	0AM/DQ200 HYDRAULIC PUMP GASKET KIT	1	0AM.GK02
	0AM/DQ200 MECHATRONIC GASKET KIT	1	0AM.GK03
	M 0AM/DQ200 VALVE BODY GASKET KIT	1	0AM.GK11
	0AM/DQ200 GASKET & SEAL KIT	1	0AM.GSK01
	M 0AM/DQ200 GASKET & SEAL KIT	1	0AM.GSK11
	0AM/DQ200 OVERHAULKIT	1	0AM.OHK01
	0AM/DQ200 OVERHAULKIT	1	0AM.OHK03
	0AM/DQ200 O-RING AND SEAL KIT	1	0AM.ORK01
	0AM/DQ200 O-RING AND SEAL KIT	1	0AM.ORK11
	0AM/DQ200 MECHATRONIC OVERHAUL/SUB KIT	1	0AM.SUBKIT01
	0AM/DQ200 MECHATRONIC CLUTCH ACTUATOR SUBKIT	1	0AM.SUBKIT02
	0AM/DQ200 MECHATRONIC GEAR SELECTORS SUBKIT	1	0AM.SUBKIT03
	0AM/DQ200 MECHATRONIC OVERHAUL/SUB KIT	1	0AM.SUBKIT11

Pump & Hydraulic Parts

REF	DESCRIPTION	QUANTITY	PART NO
701	0AM/DQ200 HYDRAULIC PUMP MOTOR	1	0AM.PUM01
800	0AM/DQ200 OIL PUMP	1	0AM.PUM02
800	0AM/DQ200 OIL PUMP	1	0AM.PUM12

Synchronizer & Selector Parts

REF	DESCRIPTION	QUANTITY	PART NO
	02J/0AM SYNCHRONIZER	1	X-02J.SYNC02
802	0AM/DQ200 SHIFT SELECTOR FORK	1	0AM.SEL01

- [Home](#)
- [0AM Transmission Catalogue](#)

Print this catalogue Favorite

Valve Bodies & Accumulators

REF	DESCRIPTION	QUANTITY	PART NO
	0AM/DQ200 MECHATRONIC OVERHAUL/SUB KIT	1	0AM.SUBKIT01
	0AM/DQ200 MECHATRONIC OVERHAUL/SUB KIT	1	0AM.SUBKIT11
750	0AM/DQ200 MECHATRONIC 0AM 325 025 M ZOX NEW CODED	1	0AM.VB03
750	0AM/DQ200 MECHATRONIC 0AM 325 025 D/H WITH TCM 0AM 927 769 D	1	0AM.VB12
750	0AM/DQ200 VALVE BODY - REMAN (DOES NOT INCLUDE TCM)	1	0AM.VB13
750	0AM/DQ200 MECHATRONIC REMAN - 0AM 325 025 L WITH TCM 0AM 927 769 G	1	0AM.VB14
750	0AM/DQ200 MECHATRONIC REMAN (2013-) - 0AM 325 025 M WITH TCM 0AM 927 769 K	1	0AM.VB15
750	0AM/DQ200 MECHATRONIC 0AM 325 026 E	1	0AM.VB18
750	0AM/DQ200 MECHATRONIC REPAIR	1	0AM.VB31
750	0CW/DQ200 MECHATRONIC	1	0CW.VB01
751	0AM/DQ200 MECHATRONIC REPAIR KIT	1	0AM.REP01
751	0AM/DQ200 VALVE BODY ACCUMULATOR HOUSING	1	0AM.VA01
752	0AM/DQ200 ACCUMULATOR	1	0AM.ACC01
752	0AM/DQ200 ACCUMULATOR - USED-	1	0AM.ACC11

0AM Transmission Catalogue

0AM [DQ200, DSG7]

For transmissions:

0AM DQ 200 DQ-200 DQ200 DSG KHM KHN KHP KJB KUT LED LKF LKG LKH LKJ LKK LKL LKM LKN LKP LKQ LPH LPJ LPK LPL LPN LPQ LQK LQM LQN LQP LSR LSS LST LSU LWW LWX LWY LWZ LXA LYG MDH MGJ MGK MGL MGM MGN MGP MGQ MGR MGT MGU MGV MLB MLC MLD MLE MLF MLG MLH MLJ MLL MLM MLN MLP MPH MPJ MPK MPL MPM MPN MPP MPQ MPS MPT MPU MPV MQE MQF MQH MQJ MSL MUV MYQ MYR NAS NAT NAU NAV NAW NAX NAY NAZ NBA NBB NBC NBD NBE NKA NKW NQA NQB NQC NQD NQE NQF NQG NQH NQJ NQK NQL NQM NQN NQP NTP NTQ NTS NTT NTU NTV NTW NTX NTY NTZ NUA NUB NUC NUD PCC PHA PKM PKN PKP PKQ PKR PKS PKT PKU PKV PKW PKX PKZ PLA PLB PMH PMJ PMK PML PPM PMN PMP PMQ PMR PMS PMT PMU PMV PMW PMX PVU PVV PVW PVX PVY PWA PWB PWC PWD PWE PWF PWH PWJ QGV QGQ QGY QHA QHB QHC QHE QHF QHG QHH QHJ QHK QHL QHM QHN QHP QHQ QHR QHS QQT QQU QQV QQW QQX QQY QZ QRA QRB QRC

QRD QRE QRF QRG QRH QRJ RAR RCQ RCR RCS RCU RCV RCW RCX RCY RCZ RDM REL REM REN REP RQN RQP RQQ RQR RQS RQT
RQU RVQ RQW RQX RQY RQZ SLQ SLR SLU SLV SLW SLX SMG [Show more](#)

- 7-speed
- Dual Clutch Transmission
- Volkswagen AG
- [Product map](#)
- [Products](#)
- [Specifications](#)

Filter results

Productgroup

Basic Overhaul Parts

Select all Bearing & Seal Kits (2) Bearing Kits (2) Clutch Kits (10) Filters - Cartridge (5) Mechatronics (7) Oils (4) Overhaul Kits (2)
 Repair Kits (1) Seal Kits (4) Service Kits (2) Solenoid Blocks (1) Valve Bodies (1)

Bearing & Seal Kits

Select all Bearing & Seal Kits (2)

Bearings, Bushings & Washers

Select all Bearing Kits (2) Bearings - Ball (2) Bearings - Needle Roller (2) Bearings - Tapered Roller (6) Shim Kits (2) Shims (25)

Sleeves (1) Slider Bearings (1)

Bolts, Nuts & Mounting Parts

Select all Caps (1) Sleeves (1)

Clutches, Flywheels & Parts

Select all Clutch Kits (10) Flywheels (10) Push Rods (2) Shim Kits (2) Shims (24)

Dipsticks, Oil & Related Parts

Select all Oils (4)

Electrical Parts

Select all Control Modules (3) Motors (1) Sensor Rings (1) Solenoid Blocks (1) Solenoids (3)

Filters & Screens

Select all Filters - Cartridge (5) Service Kits (2)

Gaskets, Seals & Closing Parts

Select all Bellows (2) Covers (6) Gaskets (21)

Housings, Cases & Parts

Select all Caps (1) Covers (3) Oil Pans (2)

Manuals, Tools & Consumables

Select all Tools - Transmission (16)

Metal Clad Seals & Seal Rings

Select all Metal Clad Seals (14) Seal Ring Kits - Rubber (3) Seal Rings - Lip Seals (1) Seal Rings - O-Rings (9)

Overhaul, Repair & Gasket Kits

Select all Gasket & Seal Kits (4) Gasket Kits (4) Overhaul Kits (2) Seal Kits (6)

Pump & Hydraulic Parts

Select all Motors (1) Pumps (2)

Synchronizer & Selector Parts

Select all Selector Forks (1) Synchronizer Rings (1)

Valve Bodies & Accumulators

Select all Accumulators (2) Housings (2) Mechatronics (7) Repair Kits (3) Valve Bodies (1)

Toon resultaten

Fluid fill information:

Transmission: 1.7 litres (0AM.OIL01)

Mechatronic: 1 litre (0AM.OIL02)

Quick order

Quick order

Enter the AC part number here to order. If you're not sure, you can [search using our vehicle lookup...](#)

[Proceed to checkout](#)

Search

Recent searches: