

B-Kit  
\* Bearing Kit

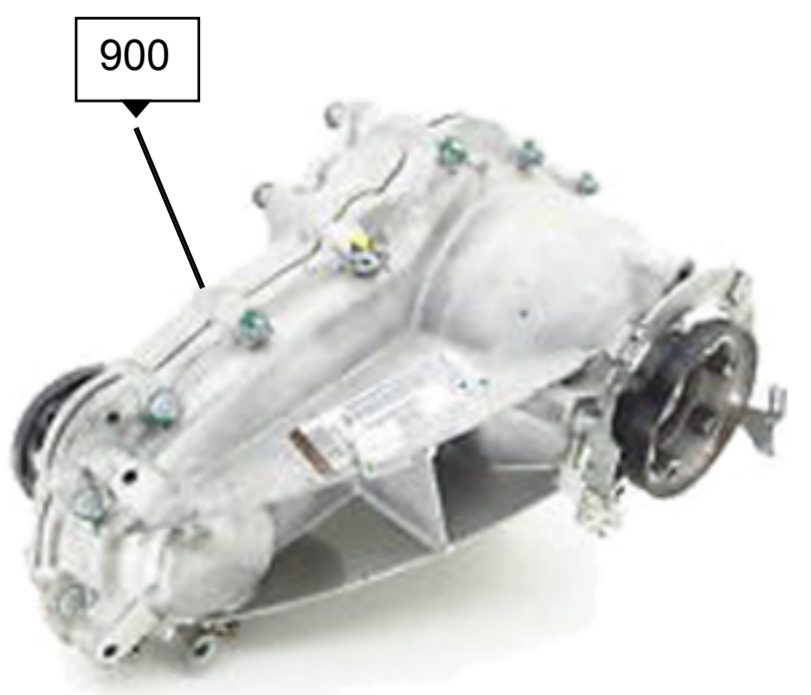
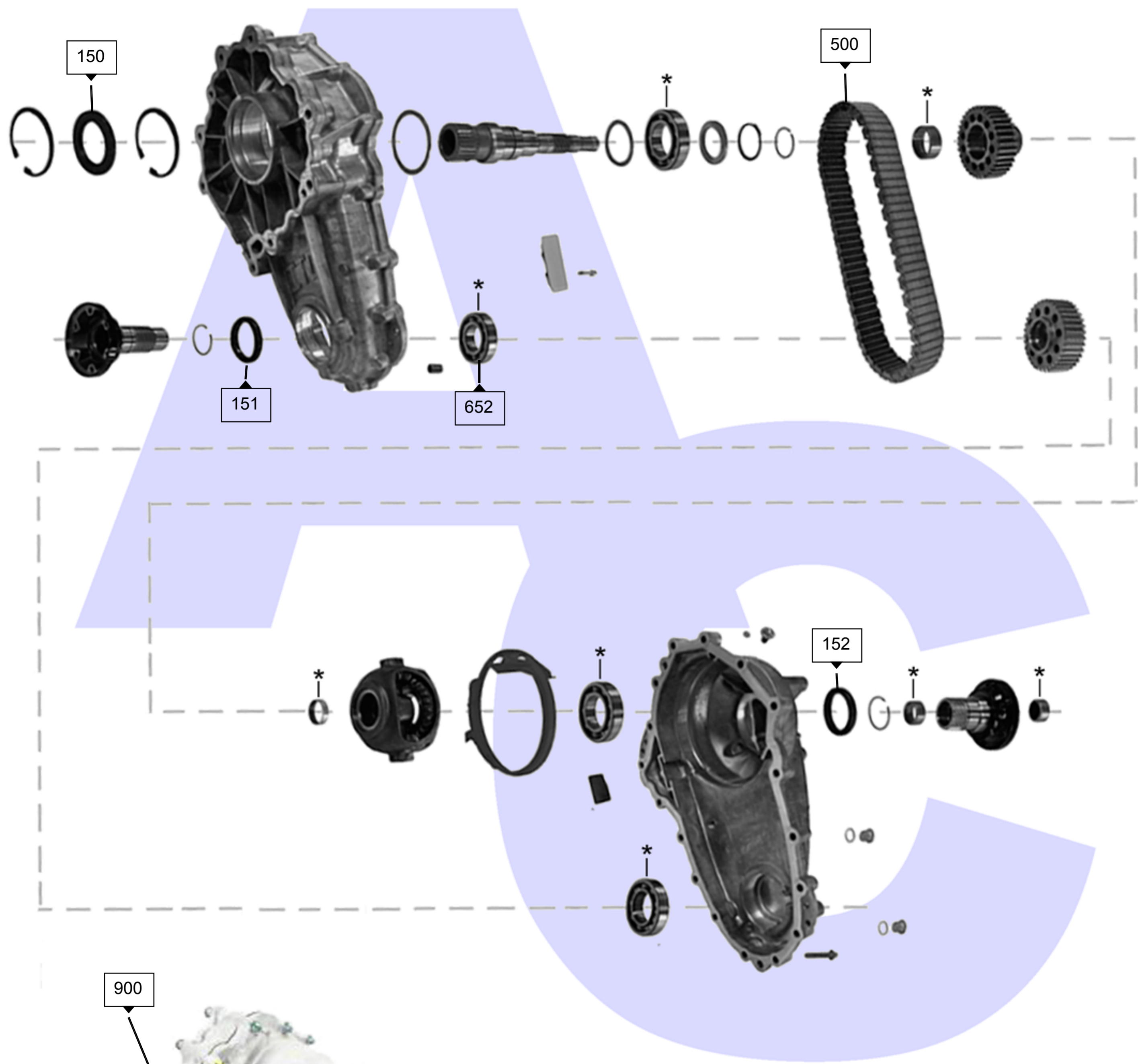

## Bearings (000174)

REF	DESCRIPTION	QUANTITY	PART NO
652	FRONT OUTPUT BEARING 6208X9 C3	1	YITC.BE02

## Transfer Case Parts (4x4) (000400)

REF	DESCRIPTION	QUANTITY	PART NO
	4-MATIC SEALING KIT (DCS)	1	Y4MATIC.GSK02
150	# 4MATIC INPUT SEAL (MERC ML 320)	1	Y4MATIC.MCS01
152	# ITC REAR OUTPUT SEAL 52 x 67 x 8	1	YITC.MCS03
500	# MERC 164 M CLASS CHAIN HV-091 38mm (no low range) 42 link	1	YMB.CH01
B-Kit	4-MATIC BEARING KIT (DSC WITH 38mm CHAIN)	1	Y4MATIC.BK02

## Transfer Case Units N (4x4) (000450)

REF	DESCRIPTION	QUANTITY	PART NO
900	# MERCEDES 4-M TRANSF. BOX (DCS) ML/GL/R CLASS 05-REMAN.	1	Y4MATIC.ASSY01A
900	# MERCEDES 4-M TRANSF. BOX ML-GL CLASS 2006-2009 REMAN.	1	Y4MATIC.ASSY06A
900	MERCEDES 4-M TRANSF.BOX M R CLASS (DCS) 2006- A251 280 22 0	1	Y4MATIC.ASSY07A
900	# MERCEDES 4-M TRANSF.BOX ML/GL CLASS (DCS) 2011-	1	Y4MATIC.ASSY09A